

# Batibox: the best choice for all your installations

**Batibox range offers a complete series of solutions for all type of walls: dry partitions, masonry and concrete.**

**The new flush mounting boxes are easy to install, ensuring a very good rigidity during the mounting process.**

## > Dry partitions

Improved technical characteristics for better fixing and wiring: large margin, reinforced fixing claws, increased volume for wires



## > Masonry

The freedom to choose the most convenient solution: multi-gang boxes (up to 4 gang) or individual boxes to be joined together



## > Multi-materials

One "universal" type of boxes for unlimited usage: masonry, dry partitions, stone,...



## > Concrete

The flush-mounting boxes for concrete can be used in three different ways: individual use, joined together or as centre point



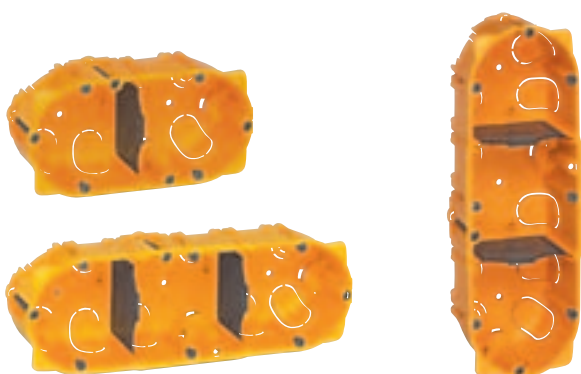

Dry partition

### > Horizontal or vertical mounting with the same box

The new multi-gang Batibox flush-mounting boxes can be equally used in horizontal or vertical position.

The internal divider can be removed in order to increase the space for wiring.



Masonry

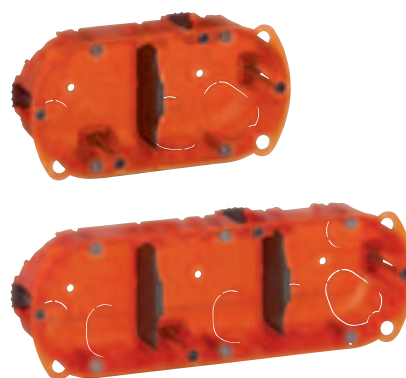

Multi-material



Concrete

# Batibox™

flush-mounting boxes for dry partitions



800 51



800 42



800 53

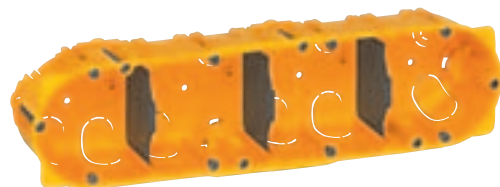

800 54

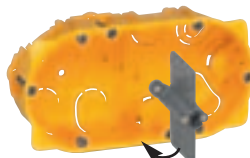

800 42 + 800 71



800 77

## 1-gang boxes

| Pack | Cat.Nos |   |
|------|---------|---|
| 20   | 800 40  | <b>For 1 Mosaic module</b><br>Drilling diameter 32 mm<br>Depth 40 mm                          |
| 50   | 800 41  | <b>For wiring accessories using screws or claws</b><br>Drilling diameter 67 mm<br>Depth 40 mm |
| 50   | 800 51  | Depth 50 mm   |
| 20   | 800 61  | Depth 60 mm   |



## Multi-gang boxes

For mounting equipment using screws  
Drilling diameter: 67 mm  
Supplied with removable dividers for accommodating extended functions (e.g. pre-wired sockets such as Plexo)

### For Mosaic and Vela

Compatible with: Galea Life, Creo, Valena, Suno and Cariva ; 71 mm fixing centres

2-gang  
Horizontal or vertical use

3-gang  
Horizontal or vertical use

4-gang  
Horizontal or vertical use

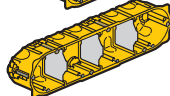
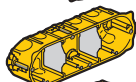

## Divider for multi-gang boxes

For installation in Batibox flush-mounting boxes  
Used for wiring devices with fixing screws in horizontal position

For 40 mm deep boxes

For 50 mm deep boxes



## Tools for flush-mounting boxes

**Installation gauge**  
For easy marking and cutting out of plasterboard in multi-gang configuration from an existing hole  
Integrated bubble level

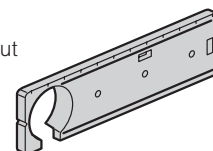

**Hole cutter**  
Supplied with centring drill  
Bi-metallic hole cutter  
Equipped with an extractor spring  
Ø67 mm 1 to 4-gang boxes  
For use in the following materials: plasterboard, wood, fibreboard, stainless steel reinforced life M3 HSS teeth  
Pilot drill with carbide tip

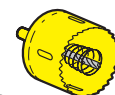

**Keyhole cutter**  
For use in plasterboard  
Equipped with an 8 mm long, 0.9 mm thick removable blade, used for cutting out positions for mounting multi-gang boxes  
Supplied with 2 interchangeable blades



## Universal covers

For converting wiring devices boxes into junction boxes or for closing up an existing box  
Supplied with fixing screws

For one-gang or multi-gang boxes

20 801 80 Round cover, Ø85 mm, for 1-gang box

20 892 81 Square cover, 80 x 80 mm, for 1-gang box

10 801 82 Cover for Batibox 2-gang box, 71 mm fixing centres



## Accessory

20 801 97 Long screw Ø3 mm length 40 mm for all Batibox boxes



## Batibox™

flush-mounting boxes for dry partitions (continued)



893 46

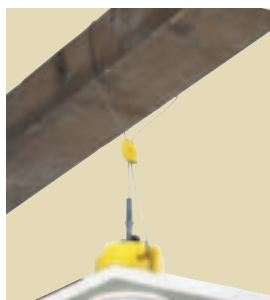

892 43 example of use

### Boxes with cover for luminaires

| Pack | Cat.Nos           |   |
|------|-------------------|---|
| 30   | <b>NEW</b> 893 36 | <b>For ceiling rose unit</b><br>Ø67 mm - depth 50 mm<br>Supplied with hook<br>Equipped with 4 Ø16-20 inputs |
| 50   | 893 46            | <b>For strip light</b><br>Ø40 mm - depth 40 mm  |



### Fixing accessories for ceiling rose units

|    |        |  |  |
|----|--------|--|--|
| 10 | 892 43 | Anchoring device<br>Quick installation by self-locking system<br>Supplied with 2 m long steel cable<br>Used to secure a ceiling rose unit by anchoring on the framework of the structure (up to 25 kg)<br>Automatic tightening of the cable without any tool<br>APAVE certified resistance |  |
| 10 | 892 86 | Threaded rod, length 160 mm for anchoring on the frame<br>Supplied with M6 nut   |  |

### Junction boxes

Supplied with cover and screws  
Knockout base

|    |        | Box ext. dim.<br>(mm) | Cover dim.<br>(mm) |
|----|--------|-----------------------|--------------------|
| 20 | 893 70 | Ø67 x 40 mm           | Ø80 mm             |
| 10 | 893 71 | Ø85 x 40 mm           | 100 x 100 mm       |
| 10 | 893 72 | 115 x 115 x 40 mm     | 140 x 140 mm       |
| 10 | 893 73 | 160 x 105 x 40 mm     | 190 x 135 mm       |
| 10 | 893 74 | 170 x 170 x 50 mm     | 195 x 195 mm       |
| 10 | 893 75 | 230 x 170 x 50 mm     | 225 x 210 mm       |

## Batibox™

flush-mounting boxes for dry partitions

### ■ Installation

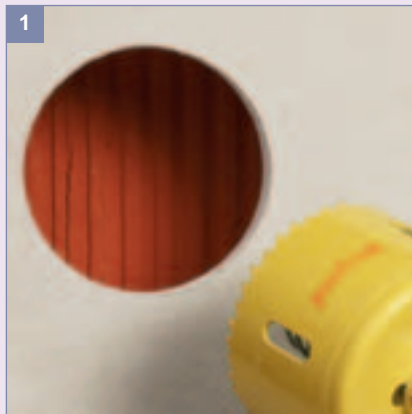

Hole cutter saw Ø67  
Box Ø67 mm, more space for cabling

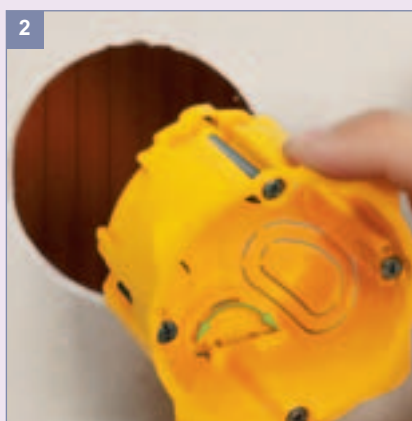

Retractable fixing claws for a better comfort during installation

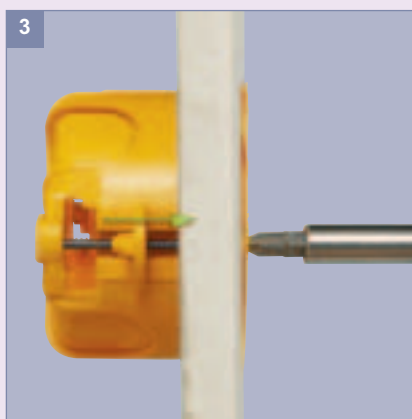

Fixing claws adapted to the thickness of the wall  
Automatic positioning, even with an electric screwdriver

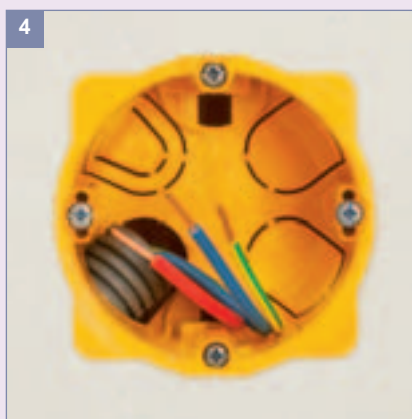

Large space to improve fixing (according to the drilling Ø67 to 68 mm)

# Batibox™

flush-mounting boxes for masonry

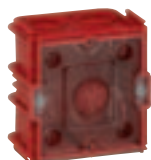

801 41 + 801 99

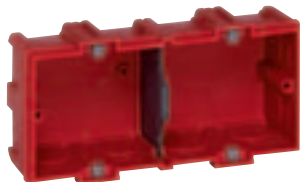

801 42



2 x 801 08 (back to back joining)

| Pack | Cat.Nos | 1-gang boxes  |
|------|---------|---|
| 10   | 801 40  | <b>For 1 Mosaic module</b><br>Depth 40 mm - Width 32 mm<br><b>Square boxes for joining together</b><br>For wiring accessories using screws or claws<br>1-gang boxes can be used to make up multi-gang boxes by joining<br>Can be used horizontally or vertically<br>71 mm fixing centres<br>Cutting out of internal partitions for mounting extended functions (e.g. pre-wired sockets such as Plexo)<br>Supplied with screws fitted with protective shield<br>Knockout cable entries, Ø16-20-255 |
| 100  | 801 41  | Depth 40 mm   |
| 100  | 801 51  | Depth 50 mm   |
| 10   | 801 61  | Depth 60 mm   |
|      |         | <b>Round</b><br>Depth 40 mm - Ø67 mm<br>Upper flange can be cut to obtain a depth of 30 mm (for controls, 2-way switches, push-buttons, etc.)<br>Boxes can be joined back to back by 1/4 of a turn<br>Adjustable dimensions (80, 70 or 60 mm) by cutting the flange   |
| 100  | 801 08  | With screws   |
| 100  | 801 09  | Without screws  |

|    |        |  |
|----|--------|--|
|    |        | <b>Multi-gang boxes for screw-mounting wiring accessories</b><br>Supplied with removable dividers for accommodating extended functions (e.g. pre-wired socket, such as Plexo)<br>Supplied with screws, fitted with protective shield<br>Depth 40 mm<br>Knockout cable entries, Ø16-20-25 |
| 10 | 801 49 | <b>For Mosaic and Vela</b><br>3 modules  |
|    |        | <b>For German standard wiring accessories</b><br>Compatible with: Galea Life, Creo, Valena, Suno and Cariva ; 71 mm fixing centres   |
| 5  | 801 42 | 2-gang<br>Horizontal or vertical use   |
| 5  | 801 43 | 3-gang<br>Horizontal or vertical use   |
| 5  | 801 44 | 4-gang<br>Horizontal or vertical use   |

|    |        |  |
|----|--------|--|
|    |        | <b>Dividers</b><br>For installation in Batibox flush-mounting boxes<br>Used for wiring devices with fixing screws in horizontal position |
| 10 | 800 71 | For 40 mm deep boxes   |
| 10 | 800 72 | For 50 mm deep boxes   |

| Pack | Cat.Nos                                | Box for 20 A and 32 A sockets  |
|------|--|--|
| 5    | Depth 40   Depth 50<br>801 84   801 85 | <b>1-gang 85 x 85 mm</b><br>For cable outlets Cat.No 314 90 and 20 A sockets (Cat.Nos 554 52/55/57) and 32 A sockets Cat.Nos 558 12/15/17<br>Vertical positioning of the screws for fixing 20 A and 32 A sockets |

|    |        |  |
|----|--------|--|
| 10 | 801 70 | <b>Boxes for fixing on door or window frame</b><br>1-gang box equipped with a fixing lug for mounting on door/window frame<br>Cutable lug for joining into multi-gang boxes<br>Depth 40 mm<br>Supplied with plaster shield |
|----|--------|--|

|   |        |   |
|---|--------|---|
| 5 | 801 55 | <b>Box for shaver socket</b><br>For Mosaic shaver socket (Cat.No 744 86)<br>Depth 50 mm |
|---|--------|---|

|    |        |  |
|----|--------|--|
| 20 | 801 97 | <b>Equipment accessories</b><br>Long screw, Ø3 mm for all Batibox boxes<br>Length 40 mm  |
| 10 | 801 99 | Plaster shield for protecting the internal volume<br>For 1 to 4-gang and multi-gang square boxes<br>Dimensions 70 x 70 mm<br>Colour marking for identifying after plastering |

|    |        |   |
|----|--------|---|
| 20 | 801 80 | <b>Universal covers</b><br>For converting flush-mounting boxes into junction boxes or for closing up an existing box<br>Round cover, Ø85 mm, for 1-gang boxes |
| 20 | 892 81 | Square cover, 80 x 80 mm, for 1-gang boxes  |
| 10 | 801 82 | Cover for Batibox 2-gang box, 71 mm fixing centres  |

|    |        |   |
|----|--------|---|
| 10 | 892 82 | <b>Covers for other boxes</b><br>For Superbox boxes Cat.No 891 26 and Batik 893 42/52<br>Dimensions 150 x 90 mm |
| 10 | 892 83 | For Superbox boxes Cat.No 891 27 and Batik 893 43/53<br>Dimensions 205 x 90 mm                                  |

## Batibox™

flush-mounting boxes for masonry



892 75

313 01

### Universal box for screw or claw mounting

| Pack | Cat.Nos |   |
|------|---------|---|
| 250  | 313 01  | Supplied without screws<br>Can be used with Mosaic, Galea, Tenara, Creo, Valena and Suno ranges,<br>Horizontal and vertical mounting<br>1-gang unit<br>Can be fitted alongside one another<br>Can be used as junction box with cover<br>Cat.No 892 81 (see below) |
| 20   | 892 81  | Cover 80 x 80 mm used in order to convert boxes<br>Cat.No 313 01 into junction boxes  |



### Luminaire boxes with cover

|    |        |   |
|----|--------|---|
| 50 | 892 56 | <b>For ceiling rose units</b><br>Ø65 mm - depth 50 mm<br>Supplied with hook |
| 50 | 892 46 | <b>For strip lights</b><br>Ø40 mm - depth 40 mm                             |



### Complete junction boxes

#### Rectangular with knockout cable entries

Boxes supplied with cover and screws  
Supplied with plaster shield (except for Cat.No 892 71)

|    |        | Box ext. dim.<br>(mm) | Cover dim.<br>(mm) |
|----|--------|-----------------------|--------------------|
| 10 | 892 71 | 85 x 85 x 40          | 100 x 100          |
| 10 | 892 72 | 120 x 120 x 40        | 140 x 140          |
| 10 | 892 73 | 165 x 115 x 40        | 190 x 135          |
| 10 | 892 74 | 175 x 175 x 40        | 195 x 195          |
| 10 | 892 75 | 230 x 180 x 50        | 255 x 210          |

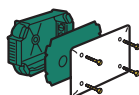

#### Large capacity

Accept Ø25 and 32 tubes  
400 x 180 x 70 mm  
390 x 245 x 70 mm

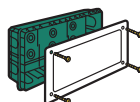

## Batibox™

flush-mounting boxes for masonry

### ■ Installation

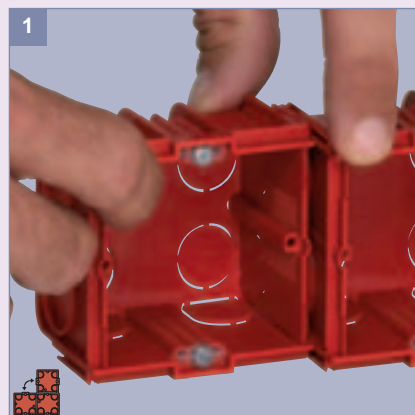

Horizontal or vertical joining of 1 gang boxes (Cat.No 801 41)



The sides can be removed before or after joining

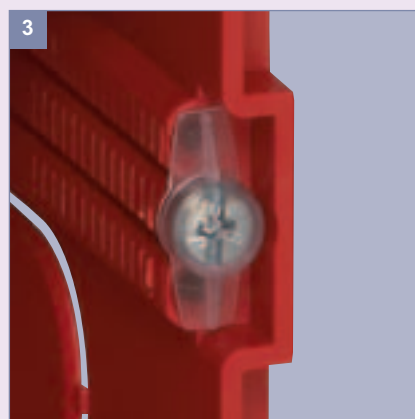

The screws are supplied with protection cap (against plaster)



Protection cover (Cat.No 801 99)  
Colour marking for identifying after plastering

# Batibox™

## multi-material flush-mounting boxes



801 01



801 02

| Pack    | Cat.Nos  |          | Multi-material boxes  |
|---------|----------|----------|---|
| 10   20 |          |          | Reinforced rigid box with many fixing methods:<br>- by gripping with metal clamps in hollow walls (plasterboard, bricks) or on plaster tiles<br>- by sealing on masonry walls (building blocks, bricks, etc.)<br>- by injection of adhesive for quick sealing<br>Equipped with captive metal clamps<br>Supplied with screws fitted with protective caps<br>Equipped with locations for injection of adhesive or sealing materials. Distribution of the adhesive visible through transparency<br>Supplied with removable dividers for accommodating extended functions (e.g. pre-wired sockets)<br>Drilling diameter 67 mm<br>1-gang |
|         | Depth 50 | Depth 40 |   |
|         | 801 21   | 801 01   |   |
| 10      |          | 801 02   | 2-gang<br>Vertical or horizontal use  |
| 10      |          | 801 03   | 3-gang<br>Vertical or horizontal use  |

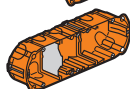

### Tools for flush mounting boxes

|   |        |  |
|---|--------|--|
| 1 | 892 68 | <b>Hole cutter</b><br>For hard materials (such as building block, brick, concrete) Ø68 mm  |
| 1 | 801 67 | <b>Tungsten carbide gritted saw</b><br>For use in very hard or abrasive materials (bricks, building blocks, tiling, cement, hard woods, composites, plasterboard, etc.)<br>Equipped with a carbide tipped pilot drill Ideal for drilling holes intended for mounting multi-material boxes Ø67 mm |

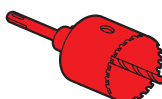

| Pack | Cat.Nos | Universal covers  |
|------|---------|---|
| 20   | 801 80  | For converting flush-mounting boxes into junction boxes<br>Supplied with fixing screws<br>Round cover, Ø85 mm, for 1-gang boxes |
| 20   | 892 81  | Square cover, 80 x 80 mm, for 1-gang boxes  |
| 10   | 801 82  | Cover for Batibox 2-gang box<br>Dimensions: 155 x 85 mm<br>71 mm fixing centres   |
| 20   | 801 97  | <b>Accessories</b><br>Long screws, Ø3 mm<br>Length 40 mm for Batibox box  |



# Batibox™

multi-material flush-mounting boxes

## ■ Installation

### Dry partitions



Use the fixing claws (supplied)

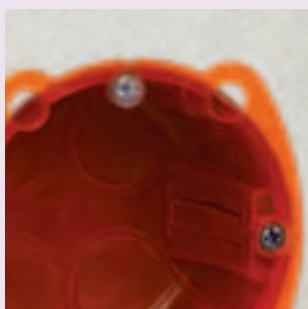

### Other type of walls

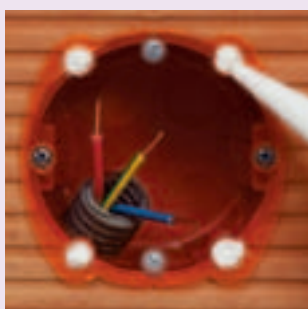

Inject the special glue

### Masonry



Traditional fixing

## ■ Example of use

Cat.No 801 01



Cat.No 801 02



Cat.No 801 03



# Batibox™

flush-mounting boxes for concrete





819 41 + 819 60 + 819 90





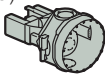
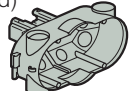

819 41 x 2



819 42

| Pack | Cat.Nos | Boxes for concrete walls   |
|------|---------|--|
|      |         | <b>Universal boxes for joining together</b><br>For mounting alone, held in position or back to back on panel, thickness 140, 160, 180, 200 mm<br>Positioning of boxes<br>- with magnet alone Cat.No 819 90<br>- held in position by combining 2 boxes back to back and magnet Cat.No 819 70 or by adding cover Cat.No 819 72 on one of the boxes<br>Can be joined together for multigang boxes<br>1-gang - depth 58 mm (screws not supplied)<br>Side by side joining possible with cover Cat.No 819 71<br>Accessories fixed using long screws Cat.No 801 97 or with ring Cat.No 819 60<br>4 x Ø20 mm coverable inputs for ICTA tube, 2 x Ø25 mm through runs for IRL tube<br> |
| 50   | 819 41  |  |
| 5    | 819 42  | <b>2-gang - depth 58 mm</b><br>Accessories fixed using screws (supplied)<br>Can be used horizontally or vertically<br>Supplied with cover accommodating the magnets Cat.No 819 70/90<br>Ø20 mm coverable inputs for ICTA tube, and Ø25 mm for IRL tube<br>  |
| 50   | 819 40  | <b>One-gang box</b><br>For mounting<br>- on metal panel with magnets Cat.Nos 819 70/90<br>- in wooden casing alone,<br>- with blanking cover Cat.No 819 72<br>- in combination side by side with installation cover Cat.No 819 71 with or without magnets<br>1-gang - depth 58 mm<br>Fixing of screw or claw-mounting wiring accessories with ring Cat.No 819 60<br>Can be combined side by side with cover Cat.No 819 71<br>   |

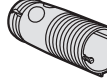
| Pack | Cat.Nos | Installation accessories for concrete boxes  |
|------|---------|--|
|      |         | <b>Fixing magnets</b><br>Resin resistant to de-casing agents<br>For boxes Cat.Nos 819 40/41/42/85<br>600 N green<br>1200 N red<br>Magnet extractor for Cat. No. 819 70/90<br>   |
| 1    | 819 70  |  |
| 1    | 819 90  |  |
| 1    | 819 97  |  |
| 20   | 819 71  | <b>Covers for concrete boxes</b><br>Fixing cover for panel box Cat. No. 819 40/41<br>Used for side by side mounting with fixing centres 86 mm or 100 mm<br>   |
| 20   | 819 72  | Installation/blanking cover used for installation on wooden casing or for blanking in back to back mounting<br>   |
|      |         | <b>Accessories for mounting equipment</b>  |
|      |         | <b>Ring</b><br>Ø64 mm ring for 1-gang box Cat.No 819 40/41<br>Supplied with screws<br>For mounting equipment using screws<br>   |
| 20   | 819 60  |  |
| 20   | 801 97  | Long screws Ø3 mm - length 40 mm for all Batibox boxes<br>For mounting directly in box Cat.No 819 41   |
| 50   | 895 28  | <b>Extension sleeve for backing wall</b><br>Used to extend the flush-mounting box for a backing wall<br>Takes screw- or clip-mounted equipment<br>Sleeve: Ø65 mm, length 150 mm max., adjustable by cutting<br>Supplied with fixing cover<br> |
| 20   | 801 80  | <b>Covers</b><br>Round cover, Ø80 mm, for 1-gang box   |
| 20   | 892 81  | Square cover, 80 x 80 mm, for 1-gang box   |
| 10   | 801 82  | Cover for Batibox 2-gang box<br>Dimensions: 155 x 85 mm<br>71 mm fixing centres  |

NEW

# Batibox™

flush-mounting boxes for concrete (continued)



895 53



895 01 + 895 53



895 53 + 895 51



895 55

| Pack | Cat.Nos | Ceiling rose equipment  |
|------|---------|---|
|      |         | <b>Ceiling rose boxes</b><br>Can be used alone in concrete slab<br>In primary slab, can be clipped on sleeve<br>Cat.No 895 51<br>Place for mounting the anchoring stick<br>Cat.No 895 54<br>Can be mounted in solid slab with weatherproof installation cover Cat.No 895 68 or reduction cover Cat.No 895 67 (or Cat.No 895 69 for Cat.No 895 51) and magnets Cat.Nos 819 70/90 |
| 20   | 895 53  | Ø85 mm box<br>Can take cover Cat.No 895 72 with reducer Cat.No 895 67   |
| 5    | 895 55  | Ø140 mm large capacity box<br>Can take cover Cat.No 895 72 with reducer Cat.No 895 67   |
| 50   | 895 51  | Ø100 mm sleeve box<br>Used alone in solid slab or in primary slab as a sleeve combined with box Cat.Nos 895 53/55<br>Can take cover Cat.No 895 71 without reducer or cover Cat.No 895 72 with reducer Cat.No 895 69   |
|      |         | <b>Electrical blocks</b><br>For mounting instead of a traditional block for flush mounting a ceiling rose unit<br>Can also be used as a reserve for passing trunking between 2 levels<br>Supplied with box Cat.No 895 53<br>Supplied with fibreglass grid for application of finishing coat   |
| 1    | 895 01  | Width 200 mm  |
| 1    | 895 02  | Width 250 mm  |

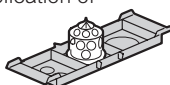

| Pack | Cat.Nos | Installation accessories (continued)  |
|------|---------|---|
| 50   | 895 70  | For ceiling rose unit sleeve box Cat.No 895 51  |
| 100  | 895 54  | <b>Anchoring stick</b><br>Length 60 mm<br>For fixing boxes Cat.Nos 895 53/55/51   |
|      |         | <b>Equipment for luminaires</b><br><b>Covers</b><br>For Ø100 mm boxes<br>For Ø60 mm boxes   |
| 100  | 895 71  |   |
| 50   | 895 72  |   |
| 20   | 895 83  | Length 85 mm  |
| 50   | 895 75  | Length 105 mm   |
| 50   | 895 84  | Length 120 mm   |
| 20   | 895 85  | Length 135 mm   |
| 20   | 895 86  | Length 160 mm   |
| 10   | 895 76  | Length 150 mm   |
|      |         | <b>Hooks for suspending luminaires</b><br>Length 85 mm<br>Length 105 mm<br>Length 120 mm<br>Length 135 mm<br>Length 160 mm<br>Length 150 mm |
|      |         | <b>Junction boxes</b><br><b>Rectangular down-lead box</b><br>Box dim. 176 x 90 x 55 mm<br>Equipped with 4 inputs of Ø20 and 25 mm           |
| 50   | 895 42  |   |
| 50   | 895 43  | Installation cover  |
| 5    | 895 44  | Capping grid for down-lead box Cat.No 895 42  |

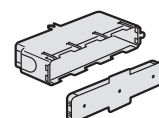
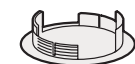

| Pack | Cat.Nos | Installation accessories  |
|------|---------|---|
|      |         | <b>Installation covers for boxes</b><br>Reducer for boxes Cat.Nos 895 53/55 (85/60 mm reduction)<br>Takes magnets Cat.Nos 819 70/90 |
| 20   | 895 67  |   |
| 50   | 895 69  | With reducer for box Cat.No 895 51 (100/60 mm reduction)<br>Weatherproof for box Cat.No 895 51 - Ø100 mm                            |

## ■ General principle

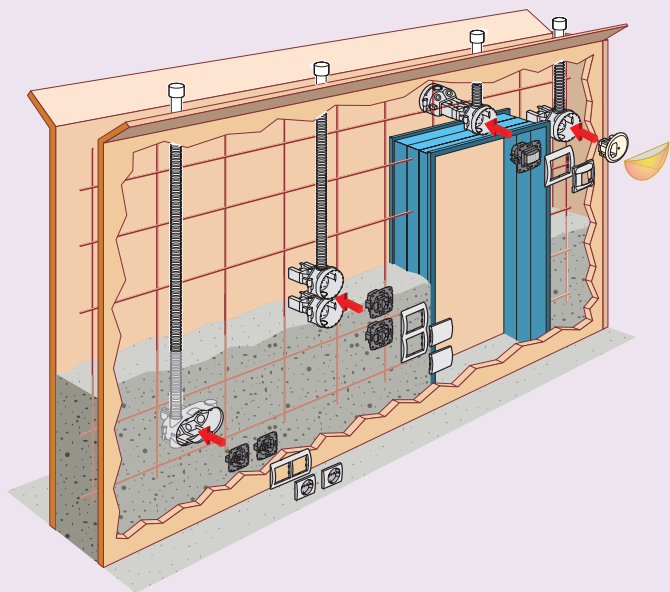

## ■ Mounting in casing

Direct mounting  
with boxes Cat.Nos 819 41/42

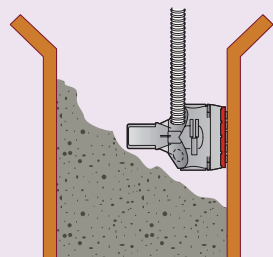

Mounting by holding in position  
with box Cat.No 819 41

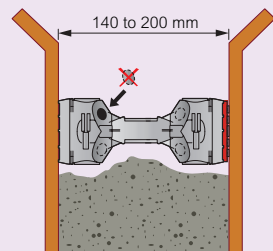

Back to back mounting

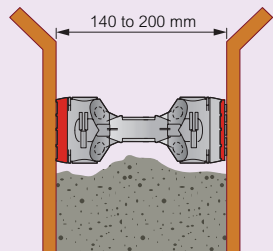

## ■ Mounting of ceiling rose units

For mounting in solid slab

Small and large capacity solutions

With Ø140 mm box

Boxes for ceiling rose units 895 55

With 85/60 mm reducer 895 67

Cover 895 72

With Ø85 mm box

Boxes for ceiling rose units 895 53

With 85/60 mm reducer 895 67

Cover 895 72

Sleeve/ceiling rose unit solution

With Ø100 mm box

895 51

Without reduction 895 70

Cover 895 71

100/60 mm reduction cover 895 69

Cover 895 72

For mounting in primary slab 60 or 70 mm

Small capacity solution

With Ø95 mm box

Boxes for ceiling rose units 895 55

895 53

895 51

Installation cover 895 70













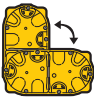

Cover 895 71

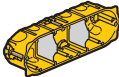
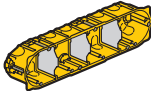
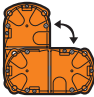
Installation cover reducing to 60 mm 895 69

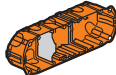
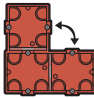
Cover 895 72

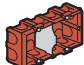
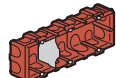
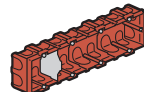
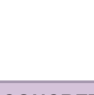
# Batibox™

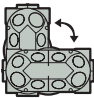
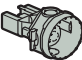
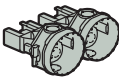
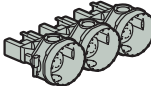
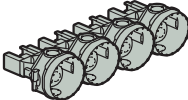
selection chart for flush-mounting boxes - German standard wiring accessories

| German standard wiring accessories<br>Galea Life,<br>Galea, Creo,<br>Valena, Suno,<br>Cariva | Depth<br>mm | HORIZONTAL OR VERTICAL MOUNTING   |   |   |  |  |   |   |            |
|--|-------------|---|---|---|--|--|---|---|------------|
|  |             | 1 GANG  | 2 GANG  |   | 3 GANG   |  | 4 GANG  |   |            |
|  |             |    |  |   |  |  |  |   |            |
| DRY PARTITIONS   |             |   |   |   |  |  |   |   |            |
|              | 40          |    | 800 41  |    | 800 42   |    | 800 43  |    | 800 44     |
|  | 50          |   | 800 51  |   | 800 52   |  | 800 53  |   | 800 54     |
|  | 60          |   | 800 61  |   |  |  |   |   |            |
| MULTI-MATERIAL   |             |   |   |   |  |  |   |   |            |
|              | 40          |    | 801 01  |    | 801 02   |    | 801 03  |   |            |
|  | 50          |   | 801 21  |   |  |  |   |   |            |
| MASONRY  |             |   |   |   |  |  |   |   |            |
|            | Square      |   | 801 41  |    | 801 42   |    | 801 43  |    | 801 44     |
|  |             |   | 801 51  |   | 2 x 801 41   |  | 3 x 801 41  |   | 4 x 801 41 |
|  |             |   | 801 61  |   | 2 x 801 51   |  | 3 x 801 51  |   | 4 x 801 51 |
|            | Round       |  | 801 08<br>with screw  |   |  |  |   |   |            |
|  |             |   | 801 09<br>without screw   |   |  |  |   |   |            |
| CONCRETE WALLS   |             |   |   |   |  |  |   |   |            |
|            | 58          |  | 819 41  |  | 2 x 819 41   |  | 3 x 819 41  |  | 4 x 819 41 |
|  |             |  | 819 40  |   | 819 42   |  |   |   |            |

# Batibox™

flush-mounting boxes for ceiling rose units and luminaires

|                       | With cover   | Accessories  |
|-----------------------|--|--|
| <b>Dry partitions</b> | 893 36 ceiling rose unit<br>893 46 strip light<br> | 892 43 anchoring device<br>892 86 threaded rod<br>   |
| <b>Masonry</b>        | 892 56 ceiling rose unit<br>892 46 strip light<br> | 892 43 anchoring device<br>892 86 threaded rod<br>   |
| <b>Concrete walls</b> |  | 895 01 block width 200 mm<br>895 02 block width 250 mm<br><br>895 83 hook length 85 mm<br>895 75 hook length 105 mm<br>895 84 hook length 120 mm<br>895 85 hook length 135 mm<br>895 86 hook length 160 mm<br> |



**World Headquarters and  
International Department  
87045 LIMOGES CEDEX FRANCE**

☎ : 33 5 55 06 87 87

Fax : 33 5 55 06 74 55